

#### ACOUSTIC PERFORMANCE

IMPACT L<sub>n</sub>TW = 54dB    AIRBORNE D<sub>n</sub>TW = 58dB    D<sub>n</sub>TW + CTR = 50dB

RESULTS ARE BASED ON THE HUSH SYSTEM HD1030 AND A MINIMUM OF 200mm DEEP JOISTS AND A FULL LATH AND PLASTER CEILING IN GOOD CONDITION.

#### SPECIFICATION

HUSH PANEL 28, ALL TEEGEE JOINTS GLUED USING HUSH-BOND, LAID OVER 19mm PLASTERBOARD PLANK, LAID OVER EXSISTING FLOORBOARDS / OSB DECK, WITH ALL PERIMETERS SEALED USING HUSH-SEAL 20.

HUSH-MESH FIREWIRE DRESSED DOWN THE SIDES OF THE JOISTS AND ACROSS THE BACK OF THE CEILING IN THE FORM OF TRAYS.

HUSH-SLAB 100 FITTED BETWEEN THE JOISTS RESTING ON THE FIREWIRE TRAY.

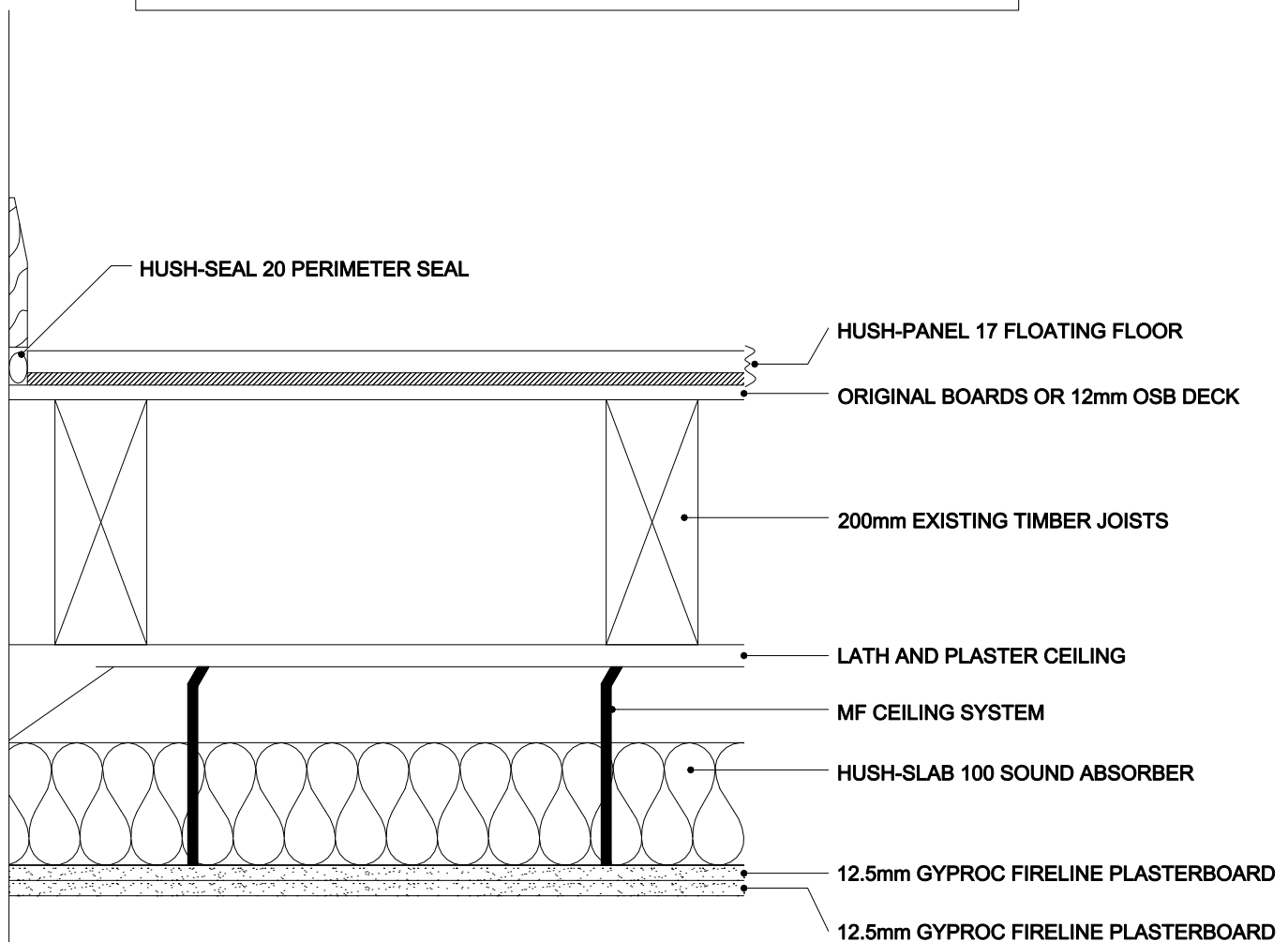

HUSH (UK) LTD  
HUSH-SYSTEM LP  
HD1033